

PHILIPS

LED Dimmer switch

Consumer Luminaires APR
Mar 2013

SED-200A



**Philips
Wall Dimmer**

SED - 200A

Wall Dimmer

Trailing Edge Dimmer

Compatible with select Philips LED Luminaires*

Built-In Switch

Switch On/Off

Overload protection.

For safety switch off if maximum wattage is exceeded

General Specs

Application	LED Wall Dimmer
Color	White
Material	Synthetic
Max Load / Hz	200W / 50Hz
Input Voltage	220-240V
Dimensions (L X W X H)mm	83.8 x 83.8 x 44.6
Cut Out (LXW) mm	60 X 60 mm
Operating Temp	0 – 45 Degree
Wire Diameter	0.75 -2.5mm ²

Compatibility Load :

LED	6 - 200W
Halogen	35 - 200W
Incandescent	10 – 200W

LED Dimmer Switch - Detailed manual

PHILIPS

SED-200A Universal Electronic Trailing Edge Dimmer
AC 220-240V 50Hz LED Luminaire 6-200W

Product part name:

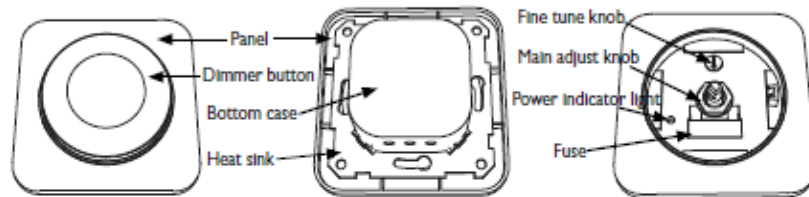

Important Notes (Please read before installing):

- 1.SED-200A is suitable for Philips luminaire only , do not connect to other luminaire .
2. Only professional operators are allowed to install.
- 3.Turn off mains, before installing or repairing.
4. Install in accordance with all national and local electrical standard. Do not remove bottom case and heat sink.
- 5.For indoor use only , operate between 0°C and 45°C.
6. Dimmer requires a minimum total lamp wattage of 6W. Do not exceed the maximum load of 200W.
- 7.It is normal for the dimmer to feel warm when it is working.
- 8.This dimmer is with overload protection. If the load exceeded the Max wattage, it will turn off automatically and won't restart until it cools down. If this occurs, reduce the wattage connected to the dimmer.
9. Suitable diameter of the wire is: 0.75 -2.5mm².
- 10.Maximum torsion for terminal screws is 0.5Nm, overtighten will cause permanent damage to the terminal screws.
11. Operate the knob of dimmer with reasonable strength.
- 12.This dimmer complies with IEC /EN60669-2-1.



PHILIPS

Addendum

4404.018.33751
Last update: 08/01/13

SED-200A 通用型后移相位调光器
AC 220-240V 50Hz LED Luminaire 6-200W

产品部件名称:

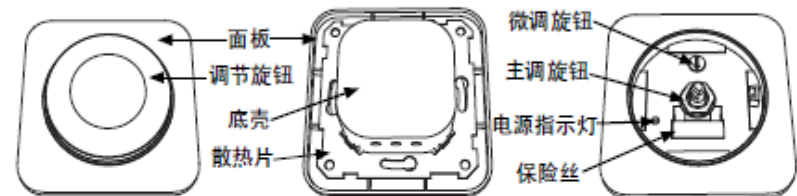

重要事项：（使用之前请参阅）

- 1、产品只应用于调光此LED照明灯具，不可用于其它灯具。
- 2、在安装或维修电路时须有专业人员进行操作。
- 3、请在进行安装或维修电路前，断开市电开关。
- 4、按照所有国家和当地的电工规定进行安装，请勿拆卸底壳和散热片。
- 5、仅限室内使用，工作环境温度介于0°C和45°C间。
- 6、调光器正常工作需要最少总计的灯功率；请勿超过最大额定功率使用。
- 7、调光器在工作期间摸上去感到温热是正常的。
- 8、本调光器有过载保护。在使用时超过了调光器额定功率，电路可能被切断，直至调光器冷却。如果出现该情况，请减少连接至调光器的功率。
- 9、接线线径为0.75-2.5mm²。
- 10、接线端子的最大扭矩是0.5Nm，过度拧紧端子螺钉可能会造成永久性的损坏。
- 11、调节时注意调节力度，以免损坏调光器。
- 12、本调光器执行IEC/EN60669-2-1标准。

LED Dimmer Switch - Detailed manual

PHILIPS

安装

1. 拆卸调节旋钮

Remove the dimming button

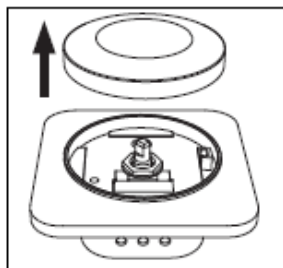

2. 拆卸保险丝

Remove the fuse

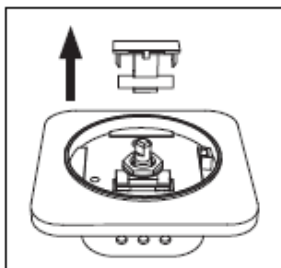

3. 拆卸螺丝

Remove the screw

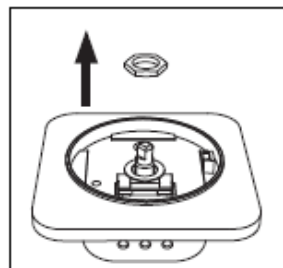

4. 拆卸垫片

Remove the gasket

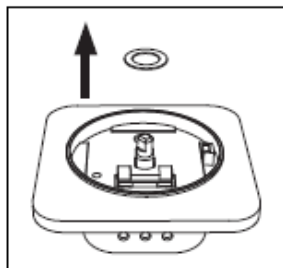

5. 拆卸面板

Remove the panel

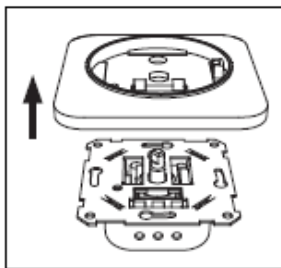

6. 接线

- ① 将底箱接线剥剪至露铜5mm。
- ② 将N线完全插入照明灯具N线端子，拧紧螺丝。
- ③ 用已经布置好的连接线将照明灯具L2线和调光器C端子相连，并拧紧螺丝。
- ④ 将L线完全插入调光器L1端子，拧紧螺丝。

Connecting wire

- ① Trim the wires, to have 5mm bare in front.
- ② Insert N wires fully into the terminals N and tighten screws.
- ③ Connect the insulated lighting wires L2 from luminaires to terminal C.
- ④ Insert wire L fully into the terminal L1 and tighten screws.

PHILIPS

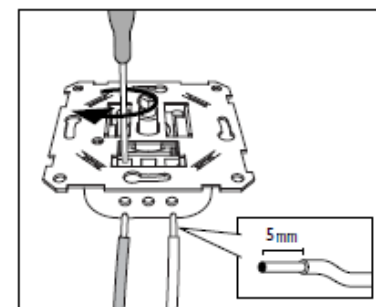
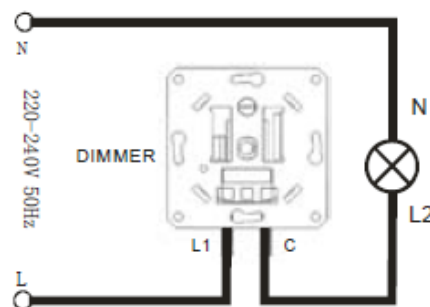

7. 安装墙壁固定螺丝

Installing the screws on wall

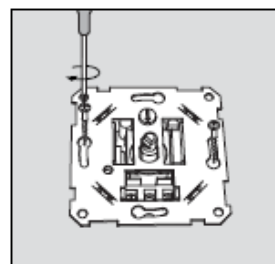

8. 扣面板

Buckling the panel

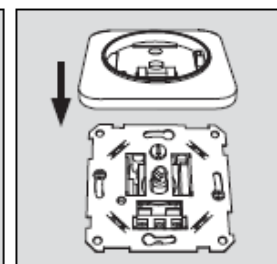

9. 安装垫片

Installing the plate

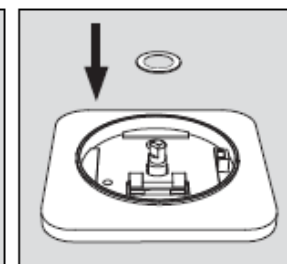

10. 安装螺丝

Tighten screw

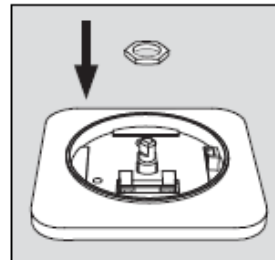

11. 安装保险丝

Installing the fuse

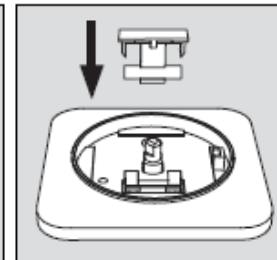

12. 扣调节旋钮

Buckling the dimmer button

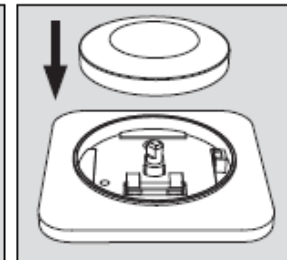

PHILIPS

Packaging

Inner Dimension: 86x86x50mm
 Diecut Dimension: 88x88x55mm
 Outer Dimension: 90x90x60

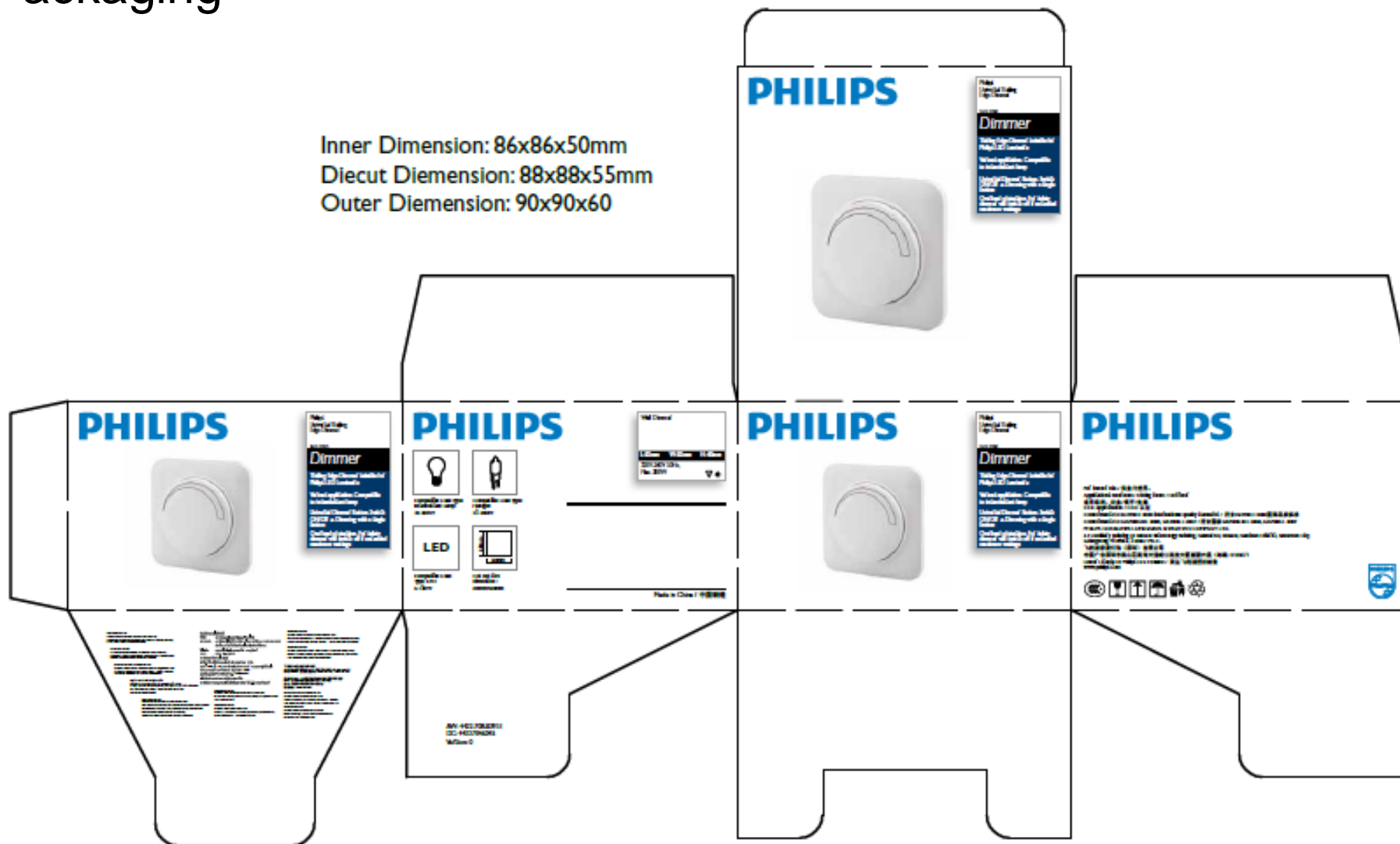

BN-PC202D01
 CC-HECHTDRUK
 100000

FAQ

- My country is running on 60Hz frequency, does the dimmer work? Does it also work on 110V input voltage?
 - No. The dimmer only works on 50Hz frequency supply. Currently we only have 50Hz available for APR.
 - This dimmer only works on 220-240 input voltage. At the moment we do not have 110V version.
- What is the minimum dimming level?
 - The minimum dimming level is 20%. This is very common among Trailing Edge LED dimmers in the market. This is primarily due to very low wattage of LED, unlike halogen & incandescent where the load are naturally higher.
- The dimmer states that 200W is the maximum load and 6W is minimum load. What does this mean ?
 - It simply means that the combination of luminaires cannot exceed 200W and cannot be less than 6W. The dimmer needs to have a minimum load otherwise it will not work properly. This is also the primary reason that most of the LED luminaires which is lower than 6W are classified as non-dimmable.
- What happen if the single or connected luminaires exceeded the maximum wattage?
 - The dimmer has an overload protection mechanism. The dimmer will automatically shut down if the maximum load is exceeded..
- How many luminaires can be connected to one dimmer switch?
 - It depends on the maximum load. eg if the load is 200W and if each LED luminaire is 10W, in theory you can connect 20 luminaires in one circuit. However, we ***do not*** recommend to utilize the maximum load due voltage fluctuation in some countries. We ***strongly*** recommend 20% below the 200w max load which is 160W. Meaning not more than 16 luminaires to be connected in one circuit.
- Why there is a heat sink in the dimmer switch?
 - When the dimmer is in operation, it also produces heat. The heat sink is to dissipate heat from the dimmer. It is normal that the dimmer will have slight warming when in operation.

FAQ

- We have just launched the Dim Tone family, which has a unique function of color temperature change. Does the dimmer work with Dim Tone?
 - Yes. The dimmer works very well with Dim Tone family. It has been tested.



- Does the dimmer works with other Philips LED ranges / bulbs?
 - We have not tested with LED bulbs. We encourage you to test the dimmer with LED bulbs for proper functionality.
 - **The dimmer has been tested only for Ledino and myLiving LED Consumer Luminaire ranges only.**
- Does the dimmer come with certifications?
 - Yes. The dimmer has a CB & CQC certification, complying to IEC standards as mentioned.

FAQ

- How do I install single & multiple luminaires in one circuit ?

- For single luminaire please refer to the diagram below.

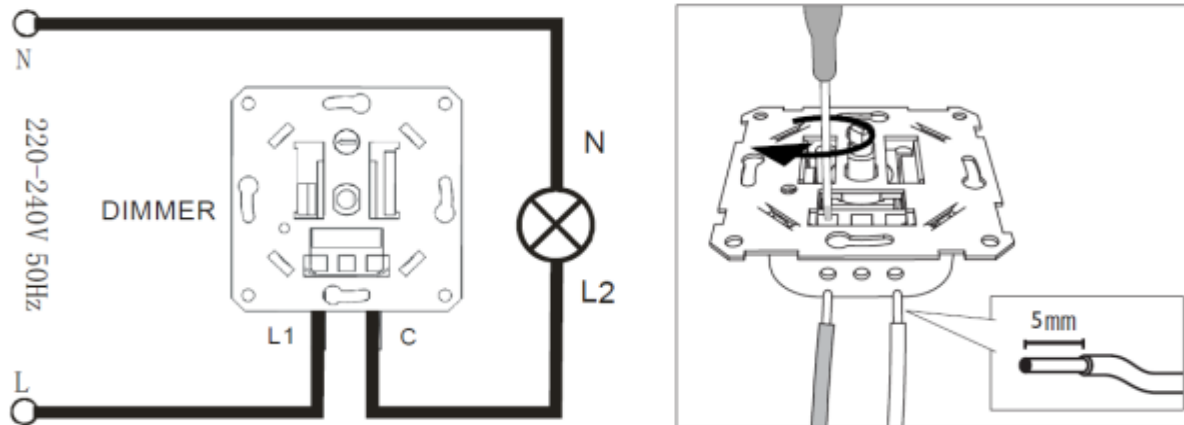

- For multiple luminaires please refer to the diagram below.

